

# 1. Product & Parts

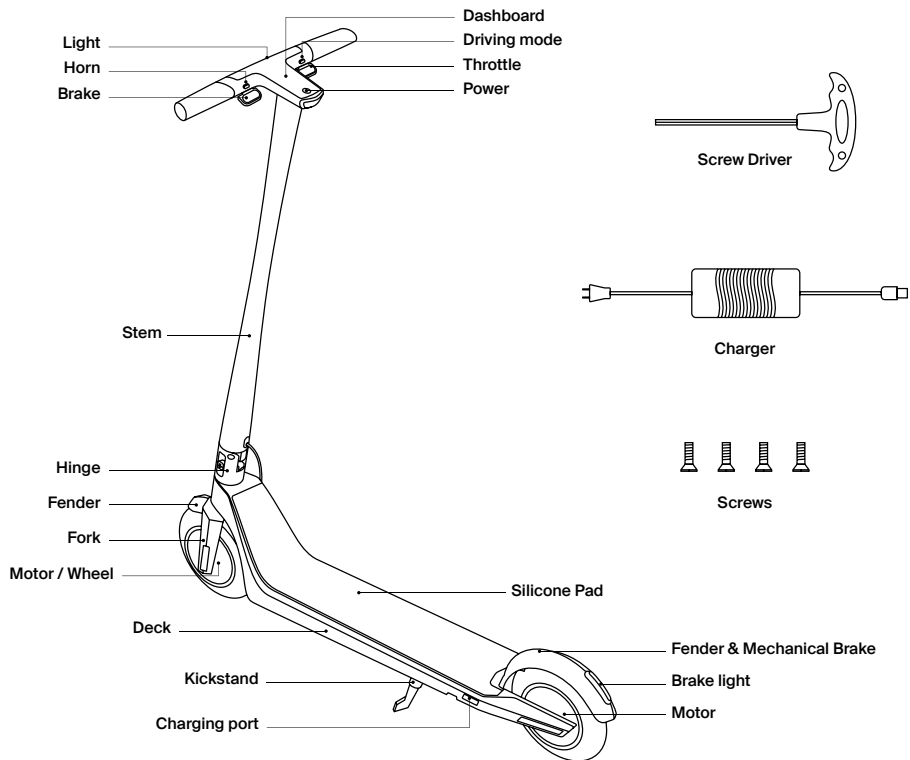

## 2. Assembly Guide

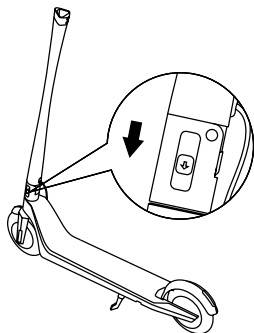

1. Press the hinge button down and fold the stem up.

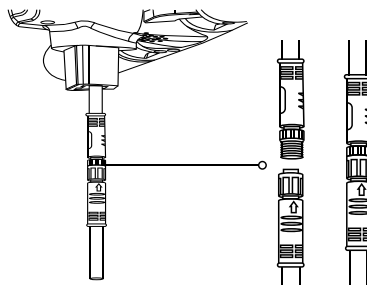

2. Connect handlebar and tube cable.

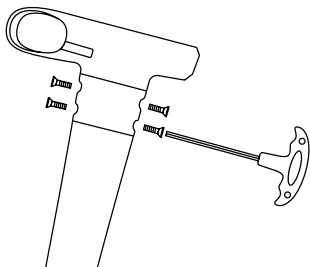

3. Use screwdriver to install handlebar screws.

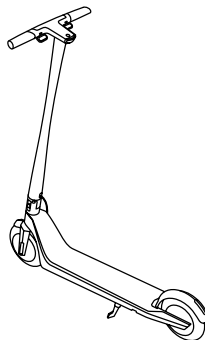

4. Turn power on.

### 3. Folding & Unfolding

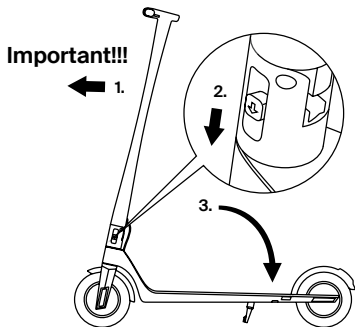

- Important!!!**
1. **Important:** Push tube forward slightly.
  2. Press hinge button down.
  3. Fold handlebar down.

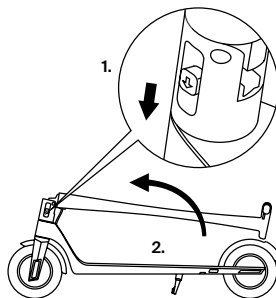

1. Press hinge button down.
2. Fold handlebar up.

**Models:** Riding Modes may vary based on regional regulations. P, 1, 2, 3. Pedestrian Mode (P) not available in all regions and all models.

## 4. Charging

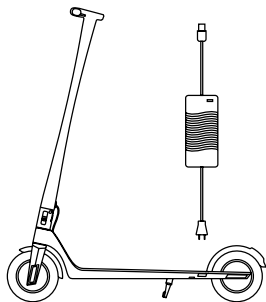

1. Plug in the charger.

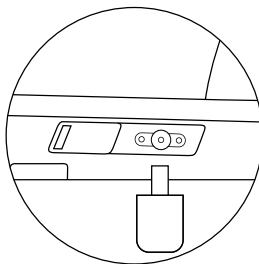

2. Open deck cover plug in.

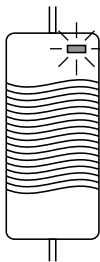

3. Green light indicates full charge.

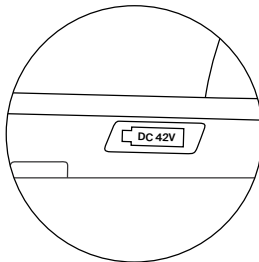

4. After charging, close deck cover.  
Scooter will not power on if charger is connected.

## 5. Handlebar & Button Guide

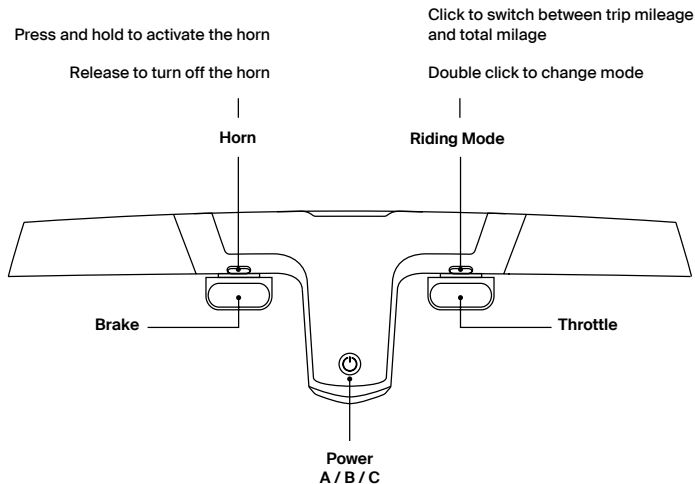

**A Power (On/Off):** Press and hold for 3 seconds. Motor will automatically turn off after 3 minutes if not in use.

**B Light (On/Off):** Click to activate or deactivate the light.

- ▶ **C Press 2 times** to alternate between single/dual motor mode. The dual motor icon will be displayed on screen when activated.

**Odometer Mode:** Press the Horn button and the Riding mode button for 2 seconds simultaneously to switch between miles and kilometers.

## 6. Dashboard

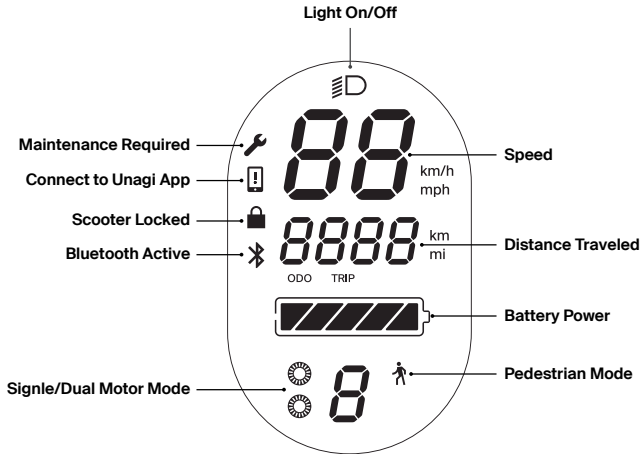

1

**Beginner (Eco-mode)**  
Riding Experience: soft and smooth  
Maximum Speed: 9.3mph

2

**Intermediate (Standard mode)**  
Riding Experience: balanced  
Maximum Speed: 12.4mph

3

**Advanced Mode (Sport Mode)**  
Riding Experience: a lot of power  
Maximum Speed: 15.5mph

P

**Pedestrian Mode**  
Riding Experience: Sidewalk  
and pedestrian area operation.  
Maximum Speed: 3.7mph - Optional

## 7. Riding Guide

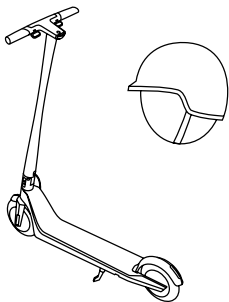

1. Please wear a helmet when riding. Check the dashboard after turning it on. Make sure you are using the beginner mode when you first start to ride.



2. Start your ride on a flat surface, put one leg on the deck the other one on the ground. Kick the ground to start.

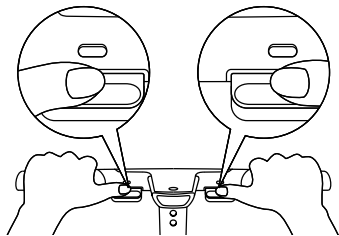

3. Put both feet on the deck after the scooter starts moving, and push gas gently. Brake when needed.

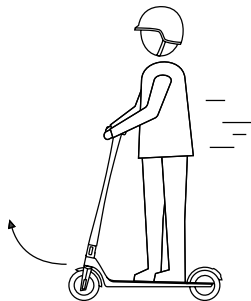

4. Slow down when turning, turn you body and handlebar slightly to the same direction you are turning the scooter.

## 7. Riding Guide

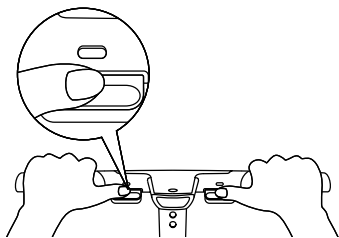

5. Use the thumb lever as your primary brake. It activates the rear brake light. The rear fender step brake can be used as needed, but does not activate the brake light.



6. Slow down for turns, turning your body and handlebar in the direction you want to turn.

## 8. Warnings

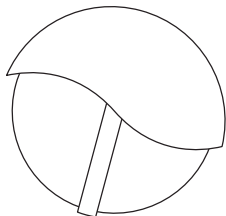

▲ Protective helmet and shoes are recommended for use.



▲ Take time to learn the basics of riding to avoid any serious accidents.



## 8. Warnings

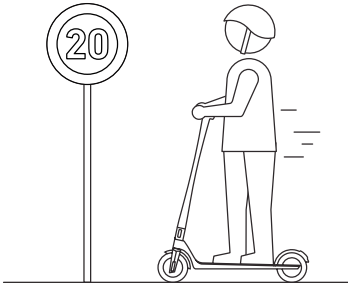

▲ Respect all traffic laws and watch for pedestrians.

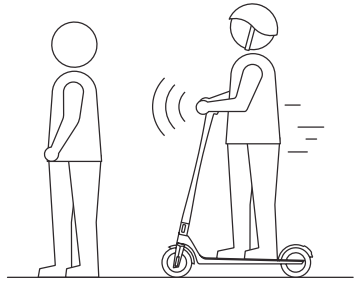

▲ Use the horn when approaching a pedestrian or cyclist when you are not seen or heard.



▲ Walk your scooter across crosswalks.



▲ Do not jump obstacles such as curbs or steps. Carry the scooter down stairs or roll it down curbs.

## 8. Warnings

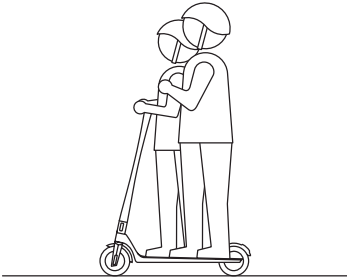

▲ Vehicle is intended for only one rider

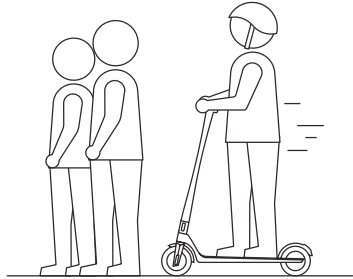

▲ Avoid high traffic areas or overcrowded areas.



▲ Use of unauthorized accessories not recommended.



▲ Any load attached to the handlebar will affect the stability of the vehicle

## 8. Warnings



▲ Use only on smooth, paved surfaces.

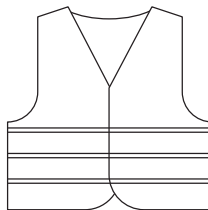

▲ Use reflective clothing and lights when riding after dark.



▲ Riding in wet conditions not recommended.

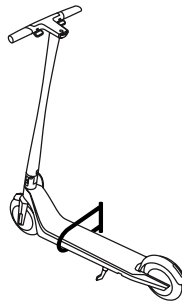

▲ You may use a long shackle u-lock to secure the scooter as shown in this figure.

## 9. Vehicle Maintenance

### Pre Ride Check

- Tires are intact with no damage
- Rear brake operates smoothly
- Handlebar can be turned smoothly from side to side

If the slider for the folding mechanism begins to bind, you may apply a light amount of graphite lubricant to the slider and the surfaces that it touches.

Do not modify or transform the vehicle, including the steering tube and sleeve, stem, folding mechanism and rear brake.

For all other services, please contact your dealer or check our website for instructions on locating a service center. You may also email us at [help@quantasklep.com](mailto:help@quantasklep.com)

### Safety Warnings

Please follow the instructions provided with the vehicle. Ride safely and under control at all times. Do not take your hands off the handlebar while in motion. Always wear a helmet and obey local traffic laws.

To reduce the risk of injury, user must read instruction manual. Prolonged exposure to UV rays, rain and the elements may damage the enclosure materials. Store indoors when not in use. Risk of fire, no user serviceable parts. Use only with specified charger in instructions.

As with any mechanical component, your quantan scooter is subject to high stresses and wear. The various materials and components may react differently to wear or fatigue. If the expected service life for a component has been exceeded, it may break suddenly, therefore risking causing injuries to the user. Cracks in the areas subject to high stresses indicate that the component has exceeded its service life and should be replaced.

# 10. Specifications

## Product Information

Product Name: Power X Dual-Motor  
Model Number: MOT41HE88  
Vehicle Weight: 13.3kg  
Vehicle Size: 111(H) \*97(L)\*41(W) cm  
Rider Limit: 35-100kg/ Age 14+  
Input Voltage: 42V/3.0A  
Max Speed: 25km/h or 20km/h depending on the country regulation  
Battery Specifications: 36VDC/10.0 Ah/360 Wh  
Capacity Charging Temperature: 0-25 degree C  
Operating Temperature Range: -10~40 degree C  
Storage Temperature: -20~50 degree C  
Charging Time: 4 hours  
IP Rating: IPX4

## Battery Information

Manufacturer: **QUANTANIUM SP z.o.o.**  
Type: Lithium Ion/ 21700 Cells  
Nominal Voltage: 36VDC  
Charging Voltage: 42VDC  
Rated Capacity: 10.0 Ah/360Wh  
Short circuit prevention  
Under voltage / Over current protection  
Over charge / discharger protection  
Automatic sleep  
Note: Not user serviceable

## Charger Information

Manufacturer: **QUANTANIUM SP z.o.o.**  
Model: UOA434424656000  
Input: 100-240V/AC 50/60Hz  
Output: DC 42V/3.0A  
Polarity: +Center  
Note: Only use the official charger supplied with the vehicle

## Bluetooth Information

**Please scan the QR code on page 2, download the corresponding APP as required, and then follow the prompts to connect**

1. After power-on, long press the Bluetooth button , the player will turn on the Bluetooth mode, and the Bluetooth identification light on the right side of the display screen will light up and flash to remind you.
2. Enable the Bluetooth function, search for Bluetooth 1221, and click Connect.
3. When the Bluetooth indicator on the LCD stops blinking and turns to steady on, the Bluetooth device is connected

## Compliance Information

### Important FCC IC Information

FCC Compliance Statement for USA

This device complies with part 15 of the FCC Rules. Operation is subject to the following two conditions:

1. This device may not cause harmful interference.
2. This device must accept any interference received, including interference that may cause undesired operation.

This equipment has been tested and found to comply with the limits for a Class B digital device, pursuant to part 15 of the FCC Rules. These limits are designed to provide reasonable protection against harmful interference in a residential installation. This equipment generates uses and can radiate radio frequency energy and, if not installed and used in accordance with the instructions, may cause harmful interference to radio communications. However, there is no guarantee that interference will not occur in a particular installation. If this equipment does cause harmful interference to radio or television reception, which can be determined by turning the equipment off and on, the user is encouraged to try to correct the interference by one or more of the following measures:

- Reorient or relocate the receiving antenna.
- Increase the separation between the equipment and receiver.
- Connect the equipment into an outlet on a circuit different from that to which the receiver is connected.
- Consult the dealer or an experienced radio/TV technician for help.

#### FCC Note

Changes or modifications not expressly approved by the party responsible for compliance could void the user's authority to operate the equipment.

#### FCC Radiation Exposure Statement

The device has been evaluated to meet general RF exposure requirement. The device can be used in portable exposure condition without restriction.

#### Industry Canada (IC) Compliance Statement for Canada

This device complies with Industry Canada license-exempt RSS standard (s).

Operation is subject to the following two

conditions: (1) this device may not cause interference, and (2) this device must accept any interference, including interference that may cause undesired operation of the device.

Le présent appareil est conforme aux CNR d'Industrie Canada applicables aux appareils radio exempts de licence. L'exploitation est autorisée aux deux conditions suivantes: (1) l'appareil ne doit pas produire de brouillage, et (2) l'utilisateur de l'appareil doit accepter tout brouillage radioélectrique subi, même si le brouillage est susceptible d'en compromettre le fonctionnement

This product complies with the IC RF exposure limit set forth for an uncontrolled environment and is safe for intended operation as described in this manual.

Ce produit est conforme aux environnements non contrôlé é s s p é cifié s dans les limites d' exposition aux rf d' ic et est s é curitaire pour les op é rations pr é vues d é crites dans ce manuel.

